

HEAVY TIMBER TRUSS & FRAME RETREAT SERIES



CHINOOK

Main Level: 3,064 sf
Upper Level: 2,134 sf
Total: 5,198 sf

The Chinook features:

- 5 bedrooms
- 5.5 baths
- Vaulted Great Room
- Open Kitchen/Dining/Living
- Timber beams and trusses

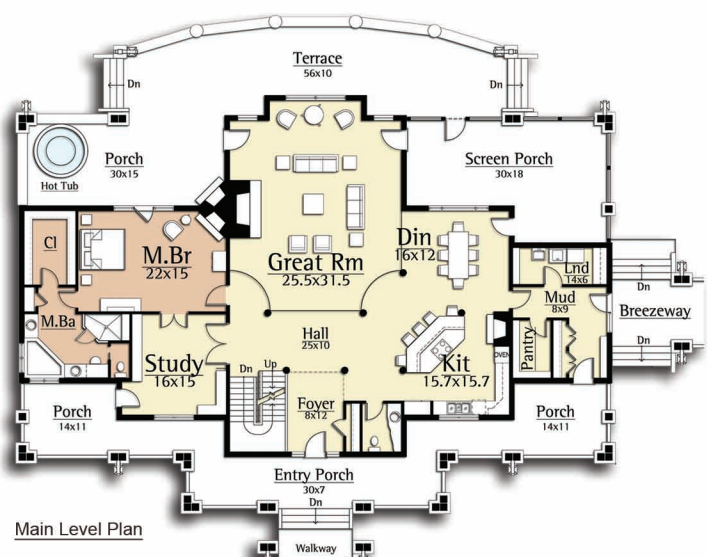
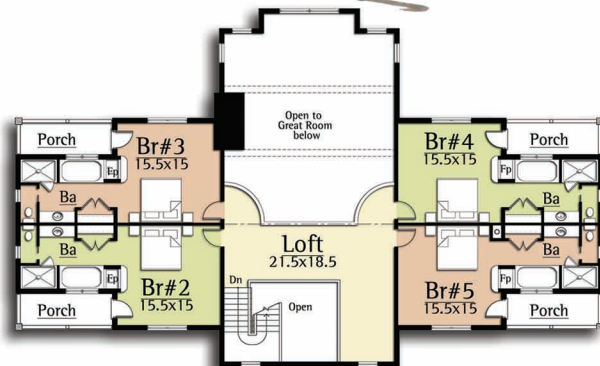

1-440-564-1090

WWW.HEAVYTIMBERS.COM

DESIGN BY

MOSSCREEK

WWW.MOSSCREEK.NET

800.737.2166